

Windsor Series® Aluminium Sun Shade

Louvreclad Windsor Series® 91x21mm slim-line aluminium louvres span up to 2400mm. Ideal for vertical, horizontal, or awning installations, offering a refined linear aesthetic and effective solar shading.

Features

PERFORMANCE

Excellent Spanning Capability

With a maximum blade span of 2400mm, Windsor Series® provides robust and reliable shading for various applications.

AESTHETICS

Slim-Line Elliptical Design

The 91x21mm elliptical profile offers a refined, linear aesthetic, perfect for modern architectural facades.

DESIGN

Versatile Installation

Suitable for vertical, horizontal, or angled configurations, adaptable for window awnings and modular sun blades.

Specifications

INSTALLATION

Installation and mounting details will be designed in accordance with proprietary systems and recommendations as designed and manufactured by Louvreclad.

Explore the profile options

Windsor Series®

91x21mm aluminium
elliptical blades

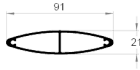
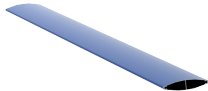

91 mm
DEPTH

21 mm
THICKNESS

2400 mm
MAX SPAN

0.88 kg/metre
WEIGHT



**DAY
DESIGN**
**PRESSURE DROP
TEST CERTIFICATE**
Test 4203Q-P

Test Specimen:
Windsor Series Louvre
Test Specimen Dimensions:

1800 mm (H) x 1200 mm (W) x 64 mm (D)

Specimen Specifications:

48% Open Area per Module

Blades @ 80 mm Pitch & 45° angle

Throat Height @ 41 mm

Test Location:

Twin Reverberation Rooms

National Acoustic Laboratories

126 Greville Street, Chatswood NSW

Instrumentation:

- Vaisala Digital Barometer (Type PTB201AD)

- Kestrel Anemometer (Model K2000)

Face Velocity (m/s)	Pressure Drop (Pa)
0.5	1.3
1.0	4.2
1.5	8.2
2.0	13.1
2.5	19.0
3.0	25.7
3.5	33.1
4.0	41.3
4.5	50.1
5.0	59.6

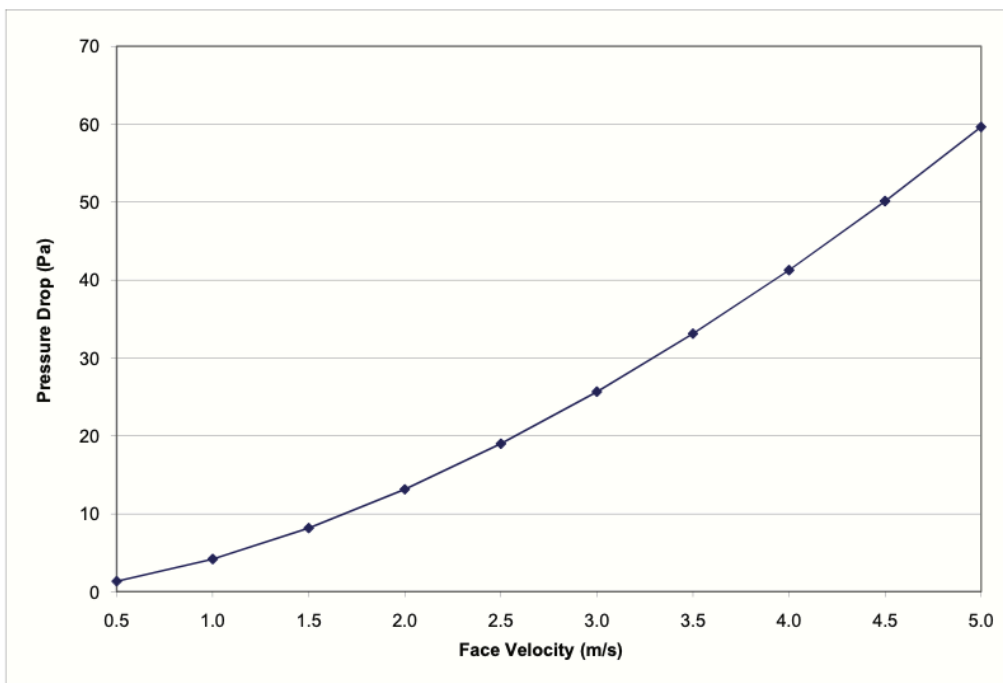
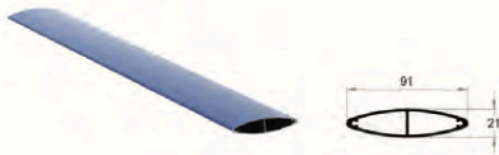

Date of Test: Wednesday, 19 August 2009
Project Number: 4203Q-P

Test Engineer: Alex Li, BE(Mech) Hons
For and on behalf of Day Design Pty Ltd

Made to Perform

1300 165 678

sales@louvrecad.com

louvrecad.com

Technical Data Disclaimer

- Indicative maximum span provided are based on generic permissible design wind pressure of 2kPa.
- Span values and product technical information provided are subjected to variance by project specific requirements & influence factors such building location, terrain category & local pressure effects.
- Span values provided are based on typical scenario where product specified are fixed at one end; simply supported at the other end and in either horizontal or vertical orientation.
- If the product specified is required to function as barrier for fall protection or as trafficable element, maximum span and pitch nominated may be reduced.
- Spans values provided could be influenced and reduced when used in dynamically sensitive wind environment.
- For project specific product selection or preliminary design & engineering consultation, please contact 1300 165 678 or sales@louvreclad.com to arrange or book a meeting.





Inspire with Quality

As leaders in the building envelope market, we are known for exceptional quality and lasting value. Our credibility, wealth of knowledge, and unmatched competence enable us to inspire exterior solutions that look good and perform better.



The MadeRight Guarantee

Following our proven process enables us to develop solutions we're proud to put our mark of quality to. We guarantee that all projects will be delivered in a timely manner, be on specification, engineered to Australian standards and finished to the highest quality.



Made to Perform

Louvreclad solutions are made to last and manufactured on-site using high-quality Australian aluminium and steel. As an organisation we are driven to get a thousand things right everyday to achieve our vision to be the face of Australian Building. Our facades are not here to be average, they are here to perform – and so are we.

Speak to an expert

Reach out today to discuss your facade solution requirements; we would love to hear from you.



Made to Perform

1300 165 678

sales@louvreciad.com

louvreciad.com